

# BF 160 S 5-A

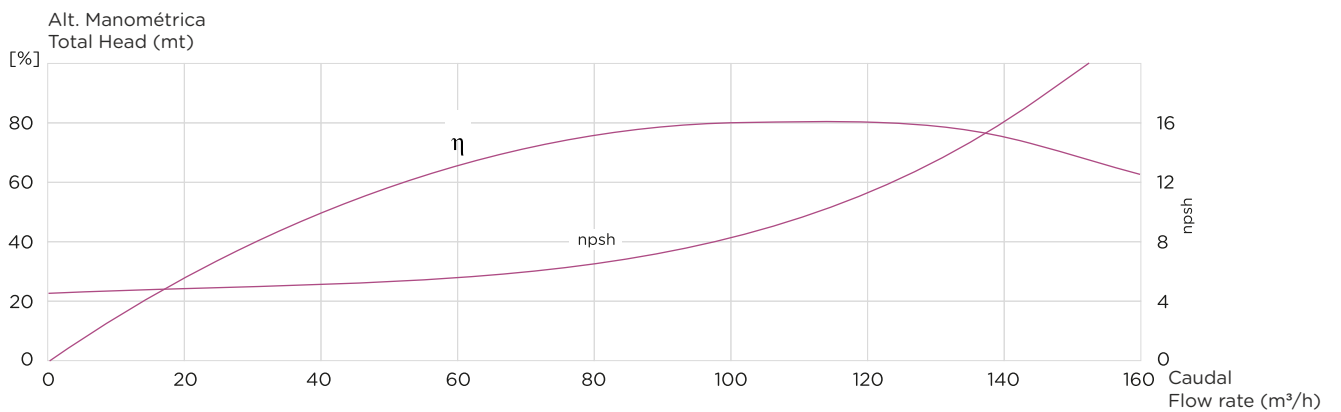
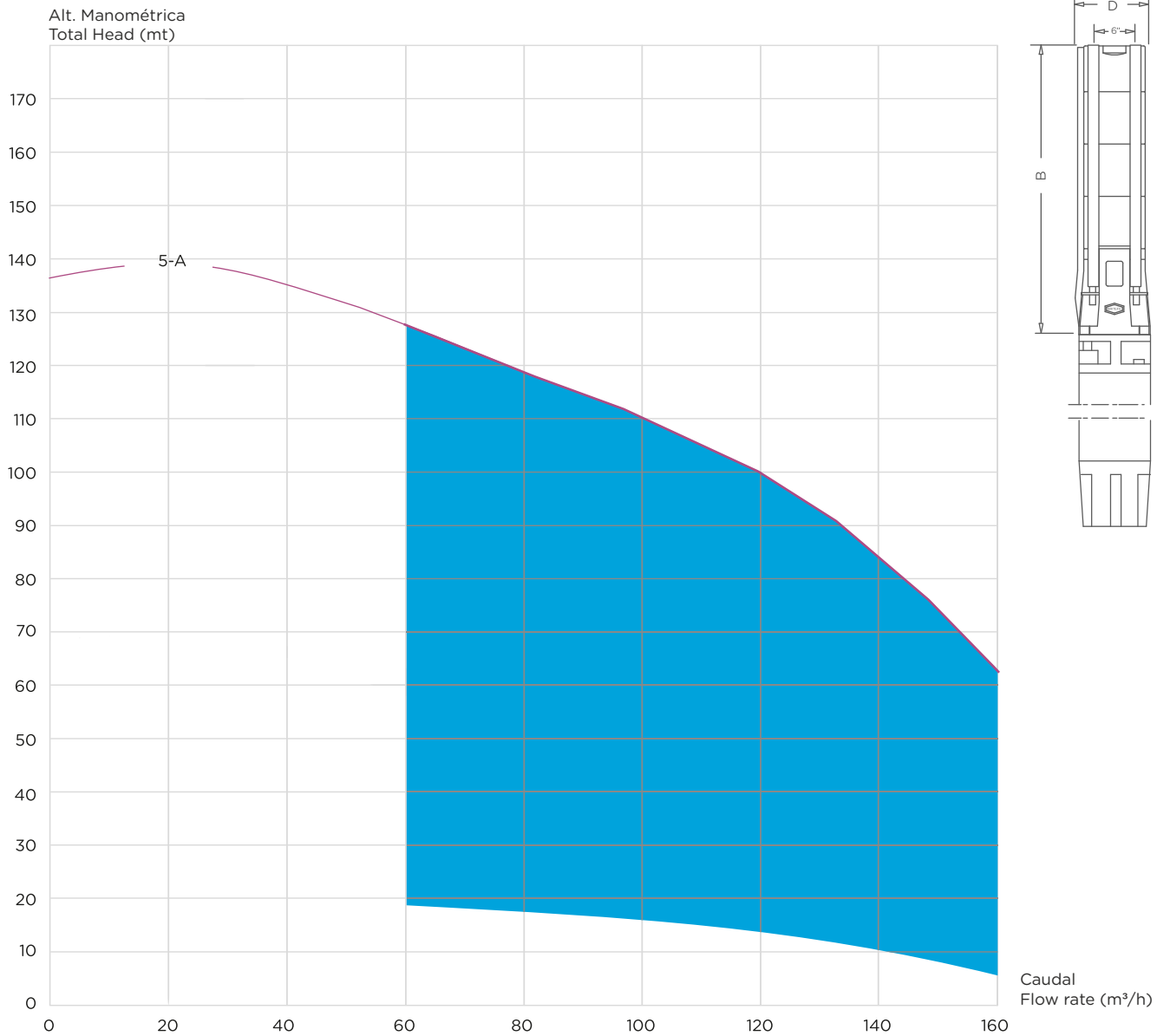

D= With 8" D.O.L. motor D= 217mm; with 8" S.D. motor D=226mm  
 D= With 10" motor D= 235mm

# COMPONENTES DA BOMBA SUBMERSÍVEL

## Components of the Submersible Pump

pos.	Todos os componentes são feitos de aço inoxidável all components are made of stainless steel		code
	Descrição   Description		
01	difusor   diffuser		1600100
03	difusor superior   top diffuser		1600300
04	turbina   impeller		1600400
05	casquilho cónico com porca   conical bush with nut		1600500
06	acoplamento do motor motor coupling flange - suction corp for motor		1600600
06	acoplamento do motor motor coupling flange - suction corp for motor		1600601
06	acoplamento do motor Start / Delta motor coupling flange - suction corp for Start / Delta		1600602
07	saída com argola discharge casing with one security rings		1600701
08	veio   shaft		16008- -(1)
09	cardan (ligações do veio do hidráulico ao veio do motor) coupling (shaft pump end / shaft motor)		1600900
10	braçadeira de acoplamento   coupling clamp		1601000
11	parafusos   screws		1601100
12	retentor da turbina   impeller fencer		1601200
13	hidroluva   shaft bearing		1601300
14	cintas de aperto   fitting belts		16014- -(1)
15	calha do cabo   cable guard		16015- -(1)
16	válvula   valve		1601600
17	retentor da válvula   valve fencer		1601700
18	rede de aspiração   suction strainer		1601800
19	argola de segurança   security ring		1601900
23	rede de aspiração   suction strainer washer		1602300

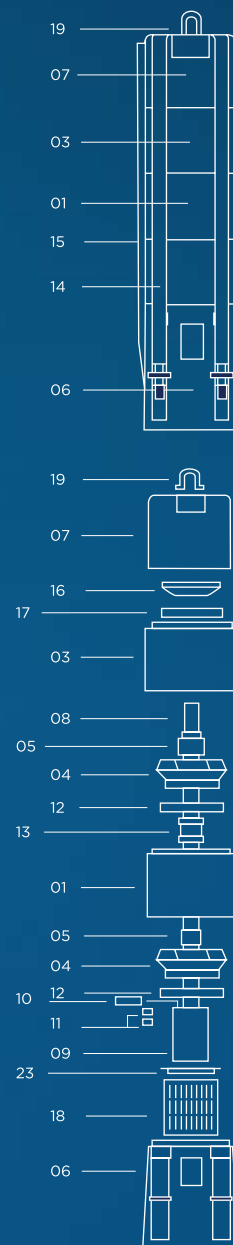

Atenção: os primeiros números dependem do tipo de bomba.  
Exemplo BF 160 (tipo de bomba) 0100= 1600100

As características da bomba podem variar sem aviso prévio.

Attention: The first numbers are depending on the pump type.  
Example BF 160 (Pump type) 0100= 1600100

The characteristics of the pump can vary without advance warning.

modèle   model type   type	moteur 6"		m3/h 1/min <small>Alt. Manométrica Total Head (mt)</small>	débit   flow rate																B (mm)	poids weight pump END 51,0 kg
	KW	HP		0	30	40	50	60	70	80	90	100	110	120	130	140	150	160			
				0	500	667	833	1000	1167	1333	1500	1667	1833	2000	2167	2333	2500	2667			
BF 160 S 5A	45	60		136	138	135	132	128	123	118	113	108	103	98	91	82	72	61	1265,0		

O comprimento total da bomba completa está ligado ao comprimento do motor usado (m).

O peso total da bomba completa está ligado ao peso do motor usado.

The total length (h) of the complete pump is linked to the length of the used motor (m).

The total weight of the complete pump is linked to the weight of the used motor.