

BF 160 S 6-AA

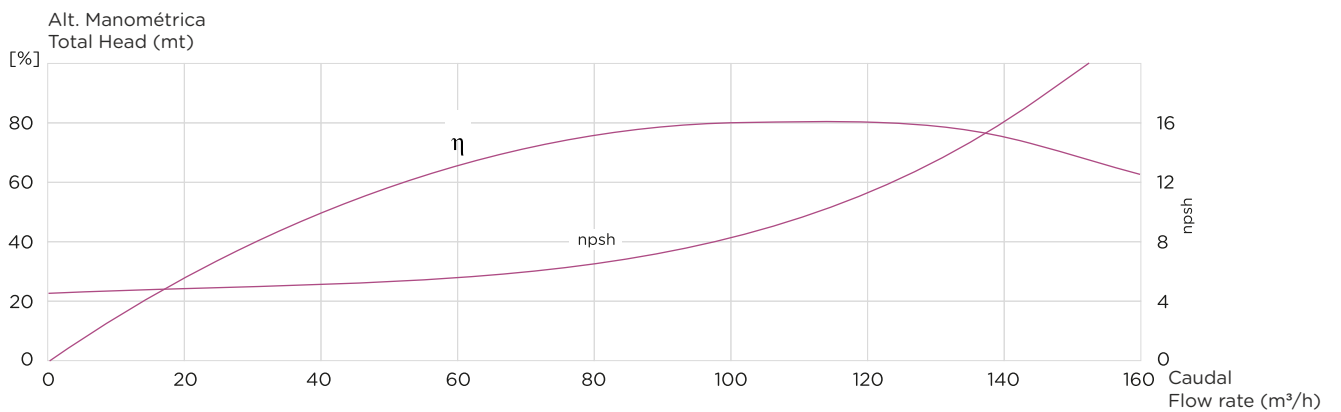
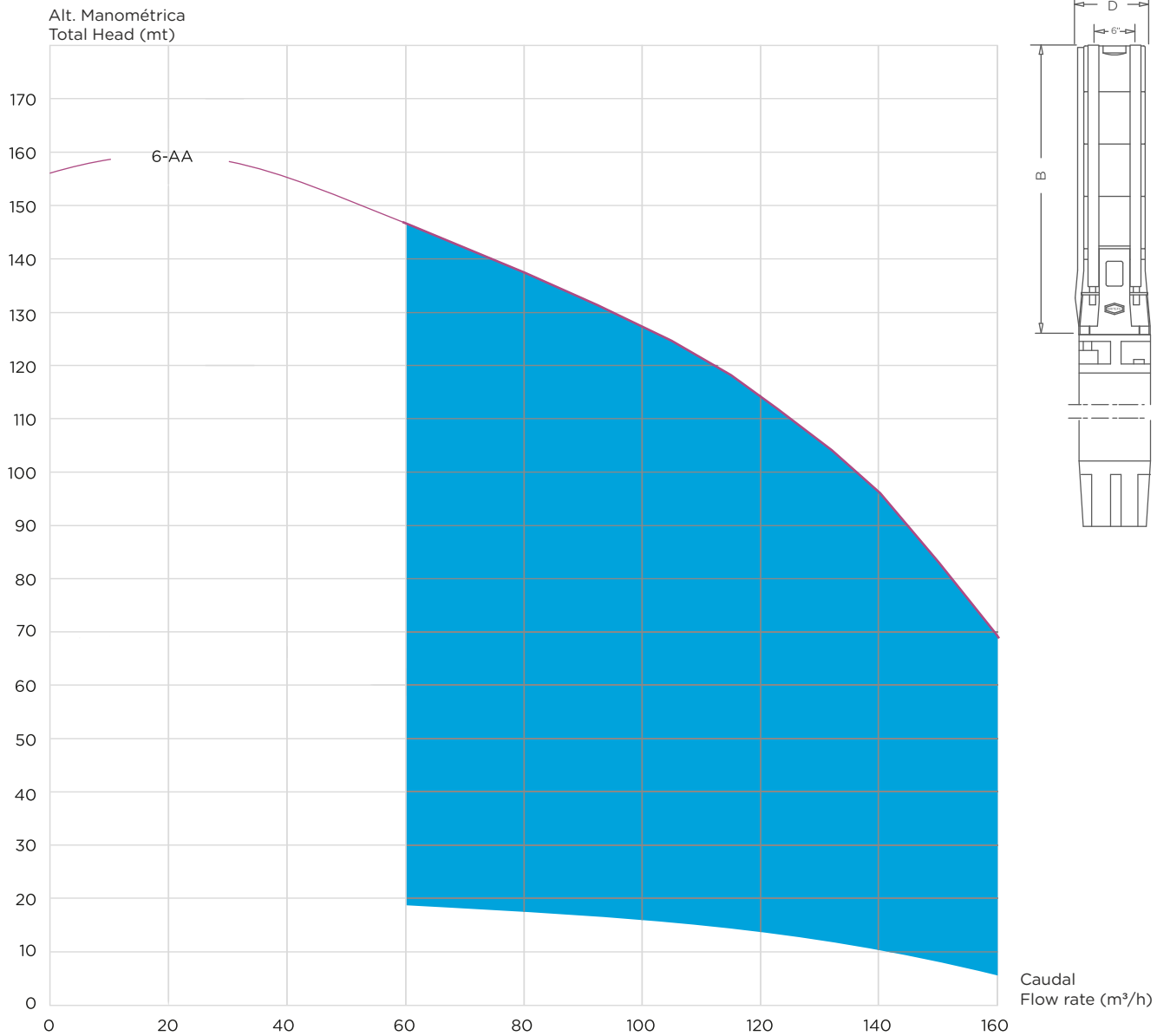

D= With 8" D.O.L. motor D= 217mm; with 8" S.D. motor D=226mm
 D= With 10" motor D= 235mm

COMPONENTES DA BOMBA SUBMERSÍVEL

Components of the Submersible Pump

pos.	Todos os componentes são feitos de aço inoxidável all components are made of stainless steel	code
	Descrição Description	
01	difusor diffuser	1600100
03	difusor superior top diffuser	1600300
04	turbina impeller	1600400
05	casquilho cónico com porca conical bush with nut	1600500
06	acoplamento do motor motor coupling flange - suction corp for motor	1600600
06	acoplamento do motor motor coupling flange - suction corp for motor	1600601
06	acoplamento do motor Start / Delta motor coupling flange - suction corp for Start / Delta	1600602
07	saída com argola discharge casing with one security rings	1600701
08	veio shaft	16008- -(1)
09	cardan (ligações do veio do hidráulico ao veio do motor) coupling (shaft pump end / shaft motor)	1600900
10	braçadeira de acoplamento coupling clamp	1601000
11	parafusos screws	1601100
12	retentor da turbina impeller fencer	1601200
13	hidroluva shaft bearing	1601300
14	cintas de aperto fitting belts	16014- -(1)
15	calha do cabo cable guard	16015- -(1)
16	válvula valve	1601600
17	retentor da válvula valve fencer	1601700
18	rede de aspiração suction strainer	1601800
19	argola de segurança security ring	1601900
23	rede de aspiração suction strainer washer	1602300

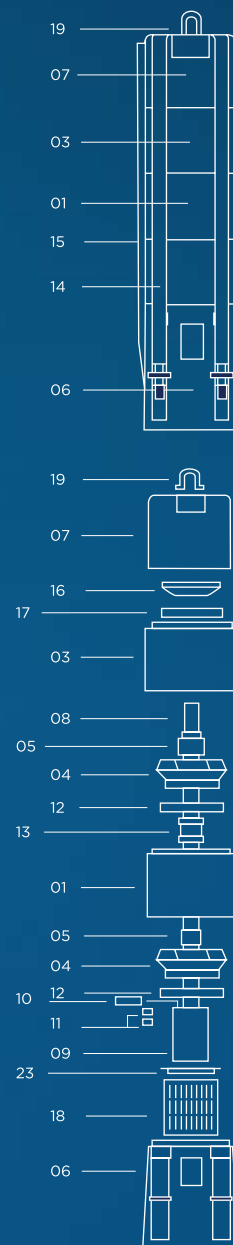

Atenção: os primeiros números dependem do tipo de bomba.
Exemplo BF 160 (tipo de bomba) 0100= 1600100

As características da bomba podem variar sem aviso prévio.

Attention: The first numbers are depending on the pump type.
Example BF 160 (Pump type) 0100= 1600100

The characteristics of the pump can vary without advance warning.

modèle model type type	moteur 6"		m3/h 1/min <small>Alt. Manométrica Total Head (mt)</small>	débit flow rate																B (mm)	poids weight pump END 57,0 kg
	KW	HP		0	30	40	50	60	70	80	90	100	110	120	130	140	150	160			
				0	500	667	833	1000	1167	1333	1500	1667	1833	2000	2167	2333	2500	2667			
BF 160 S 6AA	55	75		156	158	155	151	148	142	136	130	125	119	112	104	93	81	67	1421,0		

O comprimento total da bomba completa está ligado ao comprimento do motor usado (m).

O peso total da bomba completa está ligado ao peso do motor usado.

The total length (h) of the complete pump is linked to the length of the used motor (m).

The total weight of the complete pump is linked to the weight of the used motor.