

BF 160 S 7-AA

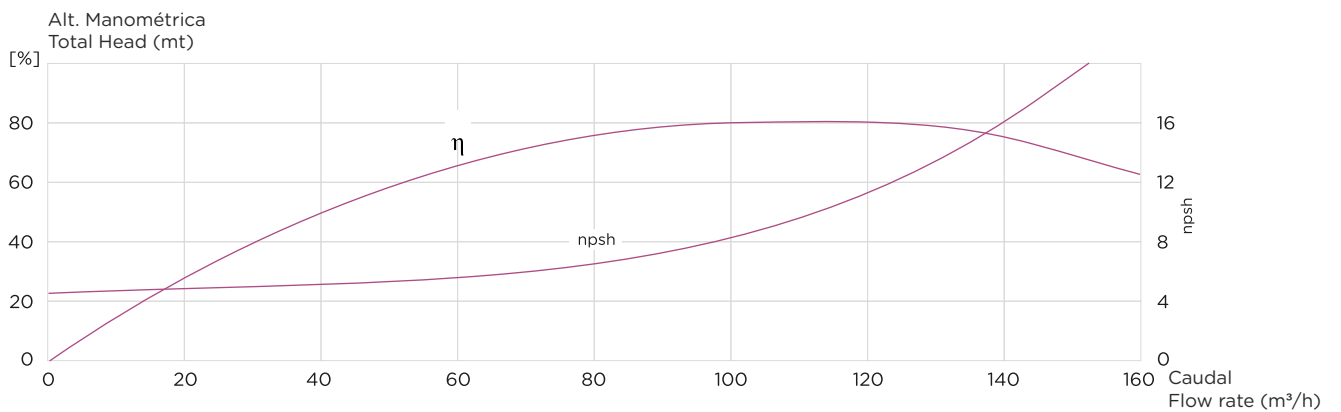
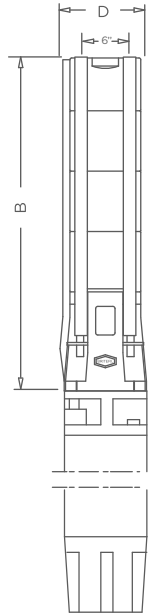
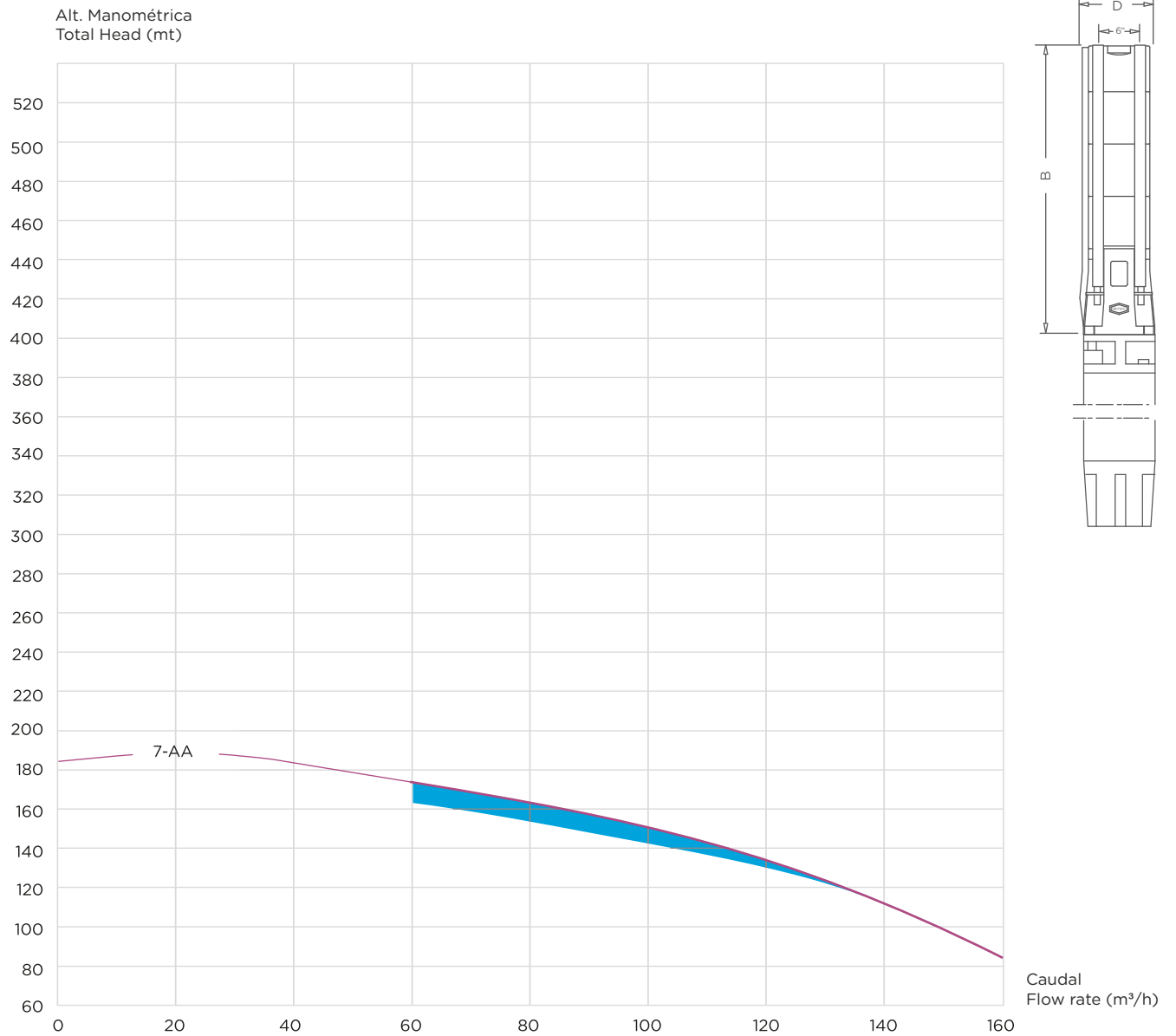

D= With 8" D.O.L. motor D= 217mm; with 8" S.D. motor D=226mm
 D= With 10" motor D= 235mm

COMPONENTES DA BOMBA SUBMERSÍVEL

Components of the Submersible Pump

pos.	Todos os componentes são feitos de aço inoxidável all components are made of stainless steel		code
	Descrição Description		
01	difusor diffuser		1600100
03	difusor superior top diffuser		1600300
04	turbina impeller		1600400
05	casquilho cónico com porca conical bush with nut		1600500
06	acoplamento do motor motor coupling flange - suction corp for motor		1600600
06	acoplamento do motor motor coupling flange - suction corp for motor		1600601
06	acoplamento do motor Start / Delta motor coupling flange - suction corp for Start / Delta		1600602
07	saída com argola discharge casing with one security rings		1600701
08	veio shaft		16008- -(1)
09	cardan (ligações do veio do hidráulico ao veio do motor) coupling (shaft pump end / shaft motor)		1600900
10	braçadeira de acoplamento coupling clamp		1601000
11	parafusos screws		1601100
12	retentor da turbina impeller fencer		1601200
13	hidroluva shaft bearing		1601300
14	cintas de aperto fitting belts		16014- -(1)
15	calha do cabo cable guard		16015- -(1)
16	válvula valve		1601600
17	retentor da válvula valve fencer		1601700
18	rede de aspiração suction strainer		1601800
19	argola de segurança security ring		1601900
23	rede de aspiração suction strainer washer		1602300

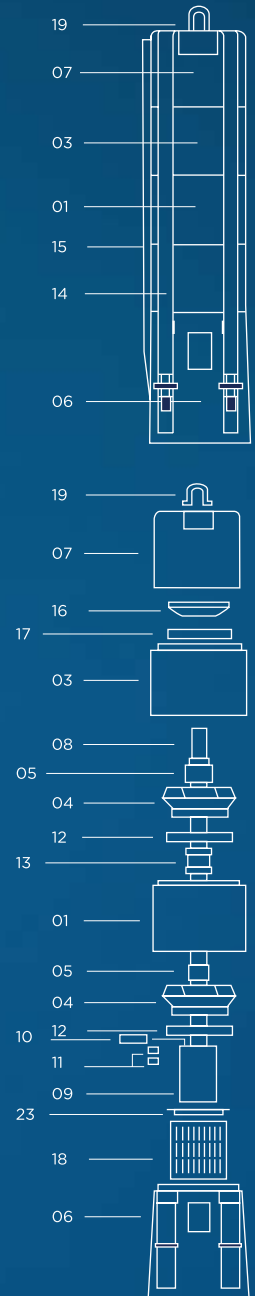

Atenção: os primeiros números dependem do tipo de bomba.
Exemplo BF 160 (tipo de bomba) 0100= 1600100

As características da bomba podem variar sem aviso prévio.

Attention: The first numbers are depending on the pump type.
Example BF 160 (Pump type) 0100= 1600100

The characteristics of the pump can vary without advance warning.

Modelo/ Model Tipo / Type	Motor 8"		m ³ /h 1/min	Caudal / Flow Rate																Peso Weigh	
	KW	HP		0	30	40	50	60	70	80	90	100	110	120	130	140	150	160	B (mm)	Weight pump END	
BF 160 S 7AA	67	90	Alt. Manométrica Total Head (mt)	185	186	183	180	175	168	162	155	149	142	134	124	112	98	81	1577,0	63,0 kg	

O comprimento total da bomba completa está ligado ao comprimento do motor usado (m).
O peso total da bomba completa está ligado ao peso do motor usado.
The total lenght (h) of the complete pump is linked to the lenght of the used motor (m).
The total weight of the complete pump is linked to the weight of the used motor.